

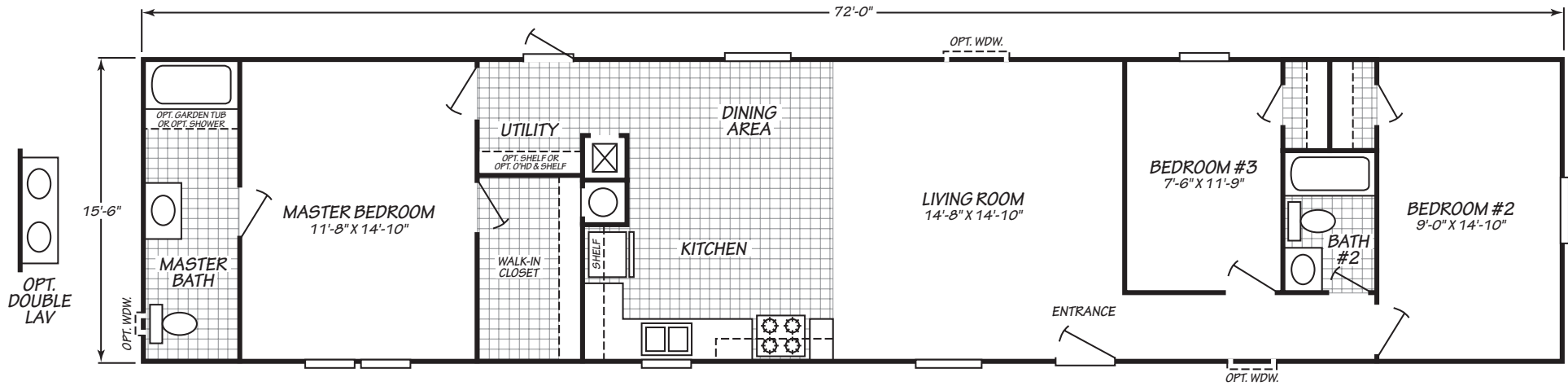

Manufactured By **FLEETWOOD**

Palm Harbor SERIES

MODEL 16723P



MODEL 16723P

3 Bedroom | 2 Bath | 1,116 Square Feet

Important: Because we continually update and modify our products, it is important for you to know that our brochures and literature are for illustrative purposes only. All information contained herein may vary from the actual home we build. Dimensions are nominal and length and width measurements are from exterior wall to exterior wall. We reserve the right to make changes at any time, without notice or obligation, in prices, colors, materials, specifications, features and models. Please check with your retailer for specific information about the home you select. This home was built to Palm Harbor plans and specifications in a building center owned and operated by Fleetwood Homes, Inc.





Manufactured By **FLEETWOOD**

Palm Harbor SERIES

STANDARD FEATURES

Construction

- 14 wide – 2x6 Floor Joists 19.2" on Center
- 16 wide – 2x8 Floor Joists 19.2" on Center
- 18 wide – 2x8 Floor Joists 16" on Center
- Tongue & Groove OSB Floor Decking
- R21 Ceiling, R11 Walls, R11 Floor insulation
- 7 Foot Sidewall on 14 Wides
- 7 1/2 Foot Sidewall on 18 Wides
- 8 Foot Sidewall (16 wides Only)
- Vaulted Ceiling Throughout
- 4/12 Roof Pitch
- Decorative Glass Light Fixtures
- Keyed-Alike Locks (except Sliding Doors)
- Insulated Aluminum Floor Duct System
- White Single Pane Windows
- 38x76 Inswing Metal Front Door with Storm
- 34x76 Outswing Slotted Window Fiberglass Rear Door

Exterior

- 14 Wide – Attractive Metal Exterior Siding with Metal Roof
- 16 Wide – LP Smart Panel Siding with Window Trim
- 18 Wide – LP Smart Panel Siding with Window Trim
- 25 Year Shingles with 20# Roof Load Construction (16 & 18 Wide)
- Exterior GFI Weather Protected Receptacle by Rear Door
- Waterheater Pan with Drain Through Exterior

Interior

- All Receptacles and Light Switches Nailed to Studs
- White 6 Panel Interior Doors with Heavy Duty Hinges
- Floor Mounted Door Stops
- 3/8" Rebond Carpet Pad
- Factory Select Carpet
- Vinyl Covered Wall Panels
- Sea Spray Paneled Ceiling
- Factory Select Décor
- 2" Blinds Throughout
- Linoleum at Front Entry
- Ventilated Vinyl Coated Shelving in Closets
- Brazilian Beaded Accents: Refer Shelf, Social Bar & Range Hood
- Accent Wall in Dining Room
- Feature Wall in Living Room
- Dining Room Buffet – Black (per plan)

Kitchen

- Black Whirlpool Appliances
- Shelf Over Refrigerator Opening
- Stainless Steel Sink with Metal Single Lever Faucet
- Drawer Bank in Kitchen
- Lined Base Cabinets Throughout Kitchen
- 30" Lined Overhead Cabinets with Adjustable Shelves
- 5 Piece Picture Frame Cabinet Doors with Hidden Hinges
- Choice of Oiled Oak or Umber Oak Cabinets (except buffet)
- Gourmet Range Hood (Spice Rack)
- Dishwasher Ready (plumb and wired)
- Shut Off Valves at Sink
- GFI Receptacles

Baths

- Single Lever Metal Vanity Faucets
- Porcelain Sinks
- Shut Off Valves at Toilets and Sinks
- 54" Tub in Guest Bath
- Mirrors Over Sinks
- GFI Receptacles
- Water Saver Commodes in all Baths
- Exhaust Fans in all Baths

Utilities

- 30 Gallon Dual Element Water Heater
- 200 Amp Interior Panel Box
- Pex Water Supply Lines
- Plumb, Wire and Vent for Washer & Dryer
- Shelf Over Washer and Dryer

Options

- Glamour Bath Package
- Appliance Package with Side by Side
- Gas Appliances
- Sliding Glass Doors
- Steel Front Door with Half-Moon Glass Insert
- Vinyl Siding (In lieu of Smart Panel on 16 and 18's)
- Tape and Texture Walls
- Textured Ceiling
- Up-Flow Air (Must do 8 foot flat ceilings. N/A on 14 & 18 wides.)
- Thermo Pane Windows

Important: Because we continually update and modify our products, it is important for you to know that our brochures and literature are for illustrative purposes only. All information contained herein may vary from the actual home we build. Dimensions are nominal and length and width measurements are from exterior wall to exterior wall. We reserve the right to make changes at any time, without notice or obligation, in prices, colors, materials, specifications, features and models. Please check with your retailer for specific information about the home you select. This home was built to Palm Harbor plans and specifications in a building center owned and operated by Fleetwood Homes, Inc.